

# CUSTOM PRINT

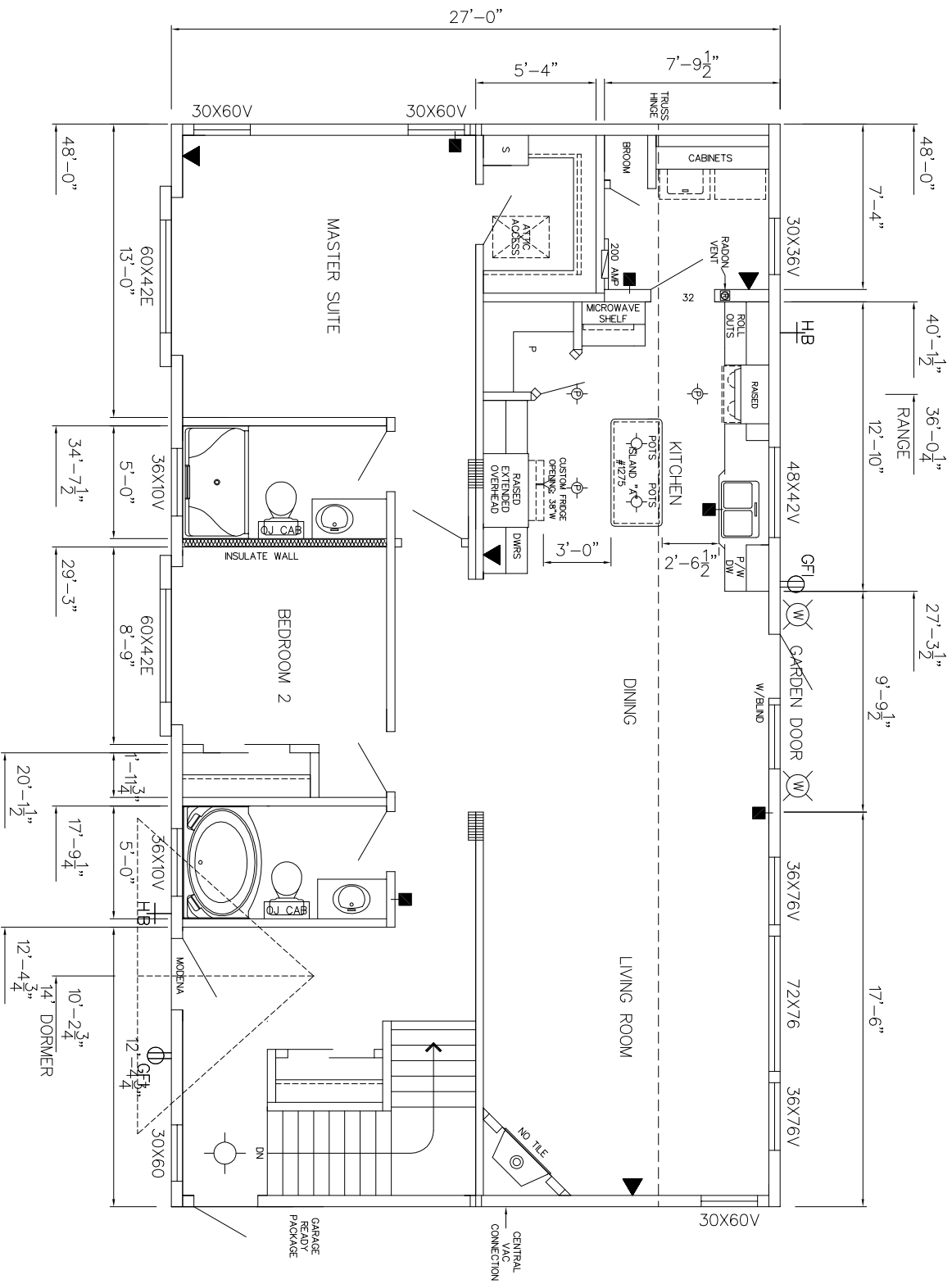

NOTES: MODULELINE ASSUMES NO RESPONSIBILITY FOR FIRE SEPARATION, SEISMIC OR DOOR/WINDOW FENESTRATION REQUIREMENTS. CONSULT YOUR LOCAL BUILDING OFFICIAL OR ENGINEER OF RECORD TO CONFIRM

CUSTOMER: \_\_\_\_\_ SIGN \_\_\_\_\_  
 DEALER: \_\_\_\_\_ SIGN \_\_\_\_\_  
 DATE: \_\_\_\_\_

A	REVISION: RADON VENT RELOCATED	DEALER CHANGE REQUEST	DATE	BY
B			01/13/2017	K.E.A.
C				

TITLE: CORNERSTONE  
 DRAWING NO.: Q10031F - CUSTOM  
 DRAWN BY: \_\_\_\_\_ K.E.A.  
 DATE: 01/31/2017

MODULINE PENTICTON  
 P.O. BOX 190  
 1175 RAILWAY STREET  
 PENTICTON, B.C. V2A 6K3  
 (250) 493-0122